



Bristnall Hall Lane

Oldbury



Bristnall Hall Lane
Oldbury

For Sale

Bristnall Hall Lane,
Oldbury, B68

3 Bedroom
Semi-Detached
House

Description

Soul Estates are proud to present this well presented 3 bedroom semi-detached house For Sale. This perfect family home is situated in a very popular area of Oldbury, with good schools primary and secondary schools with ratings 'good and outstanding. The house is close to Bristnall Hall Academy and local amenities Asda and Aldi supermarket. Good motorway network links to the M5.

The property offers an entrance porchway leading into the hallway with stairs leading to the first floor and a door leading into a spacious lounge with a bay window to the front of the property and kitchen and dining to the rear of the property. Fitted family kitchen with a range of wall and base units to match, splashback tiling, with a 6 gas burner range oven and dining area. The ground floor also benefits from a conservatory and a second sitting room.

Stairs lead to the first-floor landing which leads off to, two double bedrooms and a single bedroom and a large family bathroom. The property also benefits from gas central heating and double glazing, a large rear garden and a low maintenance front garden with ample off-road parking. The rear of the garden also benefits from an outside log cabin which can be used as an office, gym or additional storage.



The finer details



A BEAUTIFULLY PRESENTED
THREE BEDROOM SEMI-
DETACHED FAMILY HOME



SPACIOUS LOUNGE



FITTED KITCHEN & DINING
AREA



CONSERVATORY/SECOND
SITTING ROOM



STUNNING LOG BURNER IN
LOUNGE AND DINING



NEWLY FITTED BATHROOM



DOUBLE GLAZING & GAS
CENTRAL HEATING



OFF-ROAD PARKING



OFFICE/GYM TO THE REAR
OF THE PROPERTY



















GROUND FLOOR FLOORPLAN

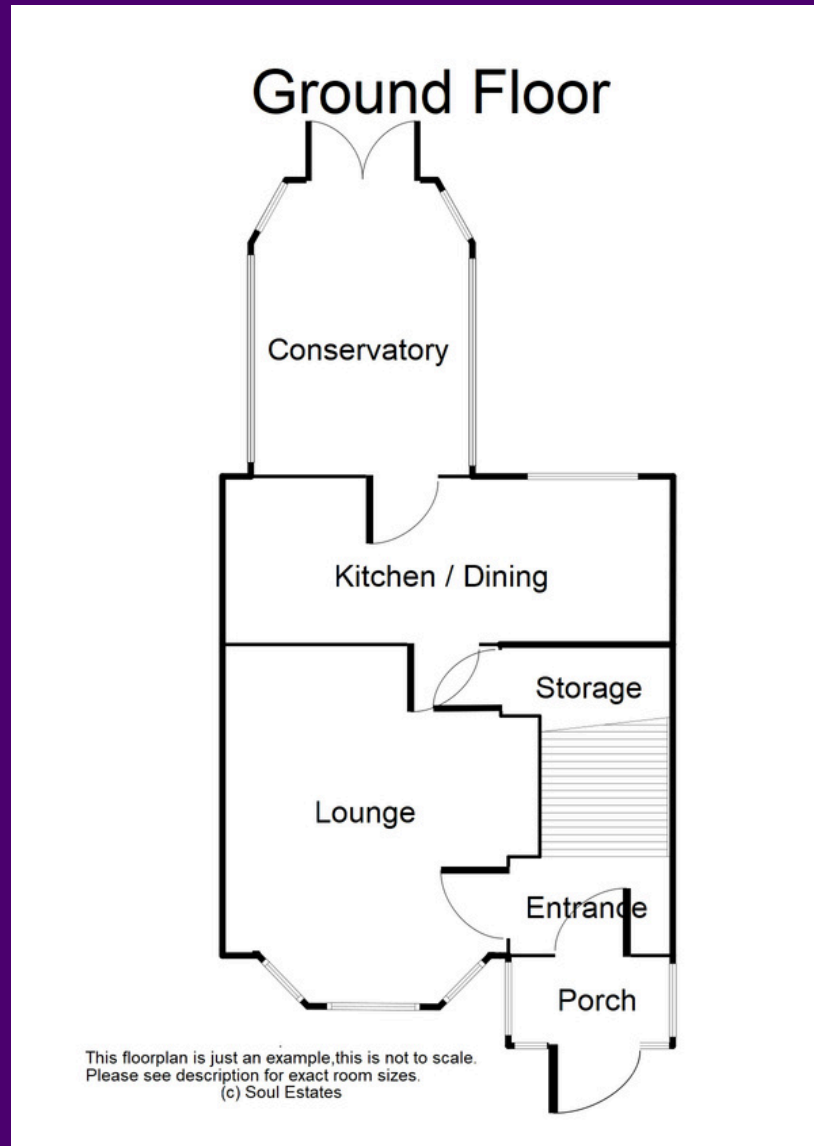

LOUNGE

14' 5" X 13' 1" (4.39M X 3.98M)

KITCHEN / DINING

6' 6" X 17' 8" (1.98M X 5.38M)

CONSERVATORY

13' 2" X 9' 2" (4.01M X 2.79M)

FIRST FLOOR FLOORPLAN

First Floor

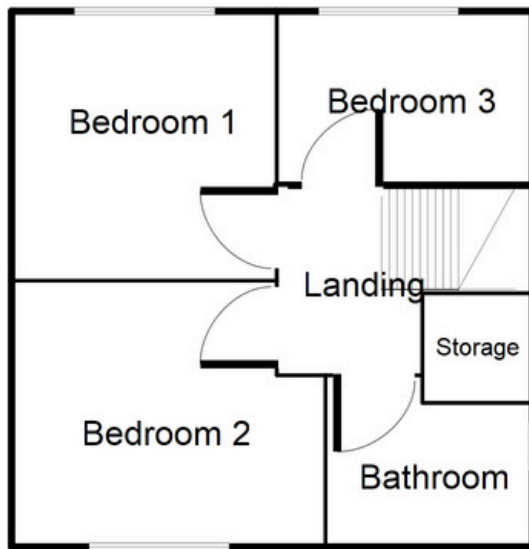

This floorplan is just an example, this is not to scale.
Please see description for exact room sizes.
(c) Soul Estates

BEDROOM ONE::

10' 9" X 9' 2" (3.27M X 2.79M)

BEDROOM TWO::

9' 10" X 10' 5" (2.99M X 3.17M)

BEDROOM THREE:

6' 6" X 9' 10" (1.98M X 2.99M)

BATHROOM:

6' 6" X 7' 10" (1.98M X 2.39M)



Bristnall Hall Lane

Oldbury

CONTACT US

Soul Estates
20 Great Bridge
Tipton
DY4 7HA

0121 647 6779

www.soulestates.co.uk

